

Tanna Hut (Sims)

Assuming 30% of volume cut. 1.0. .
not ~~merely~~ Spindly trees, 8 cbs. a day in
hauling weather, price on skidway \$5. per
cd. To notify W. Whitney if hole is
accepted. Must not begin for 10 days to 2
weeks. Whitney will locate + build skidway.

R.Y.F.

Sewer Lot

Mr. Bailey - W 40

Mr. Stone - truckman

Simon's Lot.

Logging contract to Clarence
Amidon as \$2 per c. and
chopping to Carl Swanson as
\$2 per c. Mr. Parsons will
advance the money to these men.

Mr. Stone is doing bushing for Whitney
Mr. Bailey is representing D.

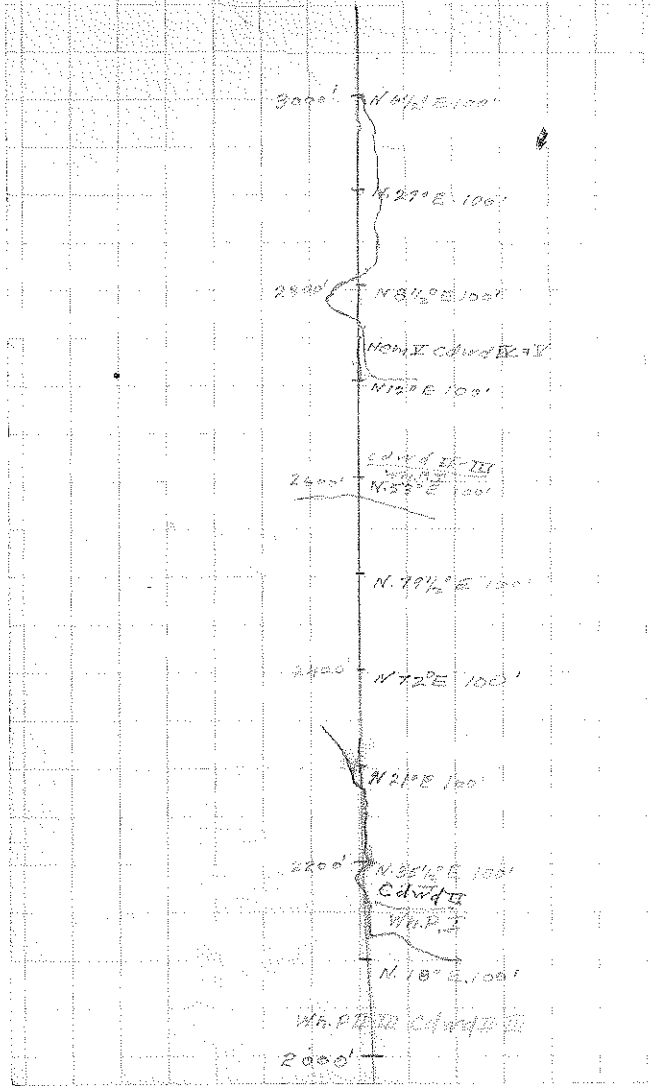

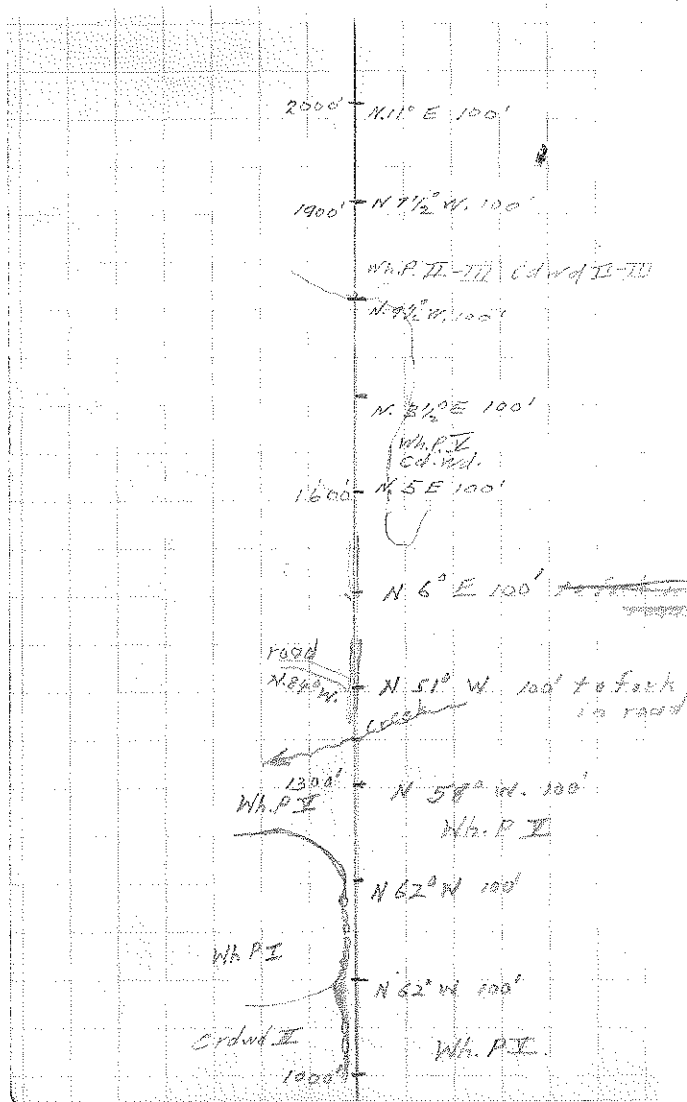

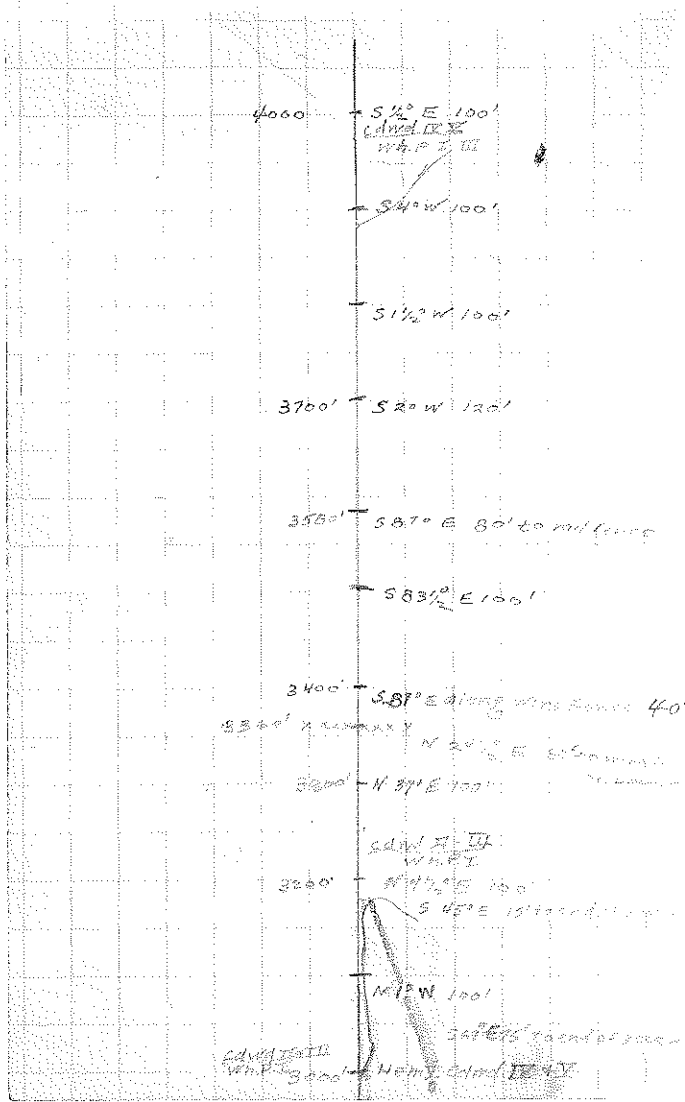

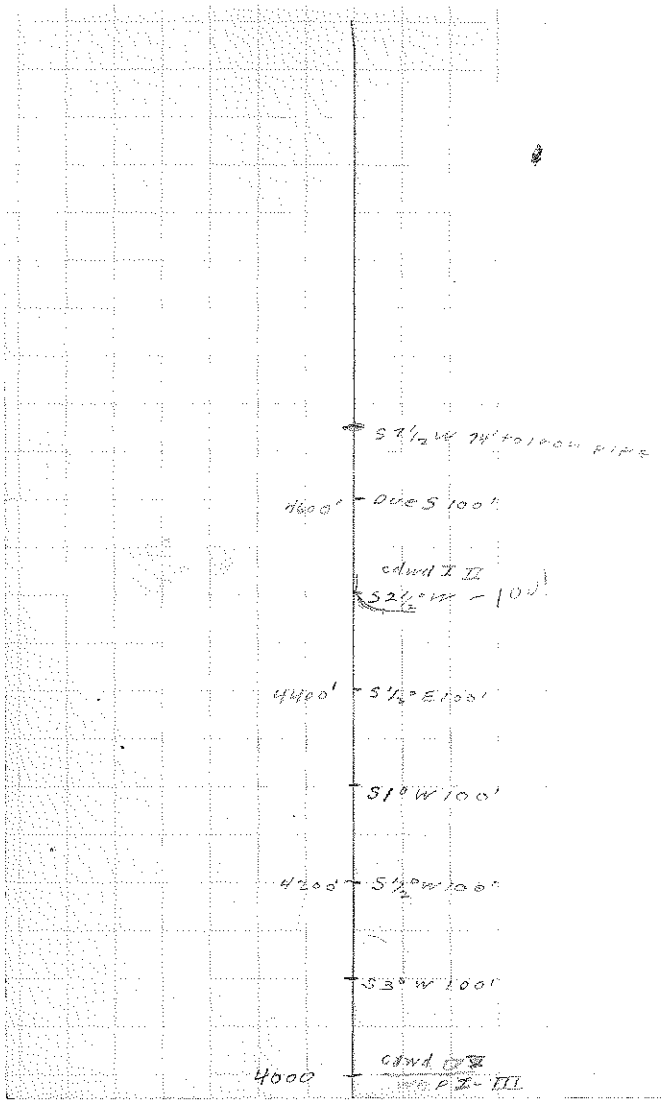

46 CHESTNUT STREET
BOSTON, MASSACHUSETTS

Jan. 31st

Dear Mr. Plim

I am inclosing you two books which possibly may interest you, but don't feel obliged to read them, even though I may ask you some time if they are worth the effort. Keep them as long as you like, unless you are through, just hand them over to Mr. Parsons.

I am off for the West tomorrow, perhaps shall have

A better word to speak for the
redwoods when I get back, as
I saw them at an unfavorable
season before.

I am writing Miss Williams
that I cannot decide about
the wood for until I have a
fairly accurate idea of its
value.

Sincerely yours

Oliver Silliman

Benjamin F. Lawrence

Battlett T E Co.

230-40 Main St.

Greenfield, Mass

THE F.A. BARTLETT TREE EXPERT CO.
Home Office
STAMFORD ~ CONN.

RICHARD R. FENSKA
42 Pleasant Street
Room 5
Northampton, Mass.

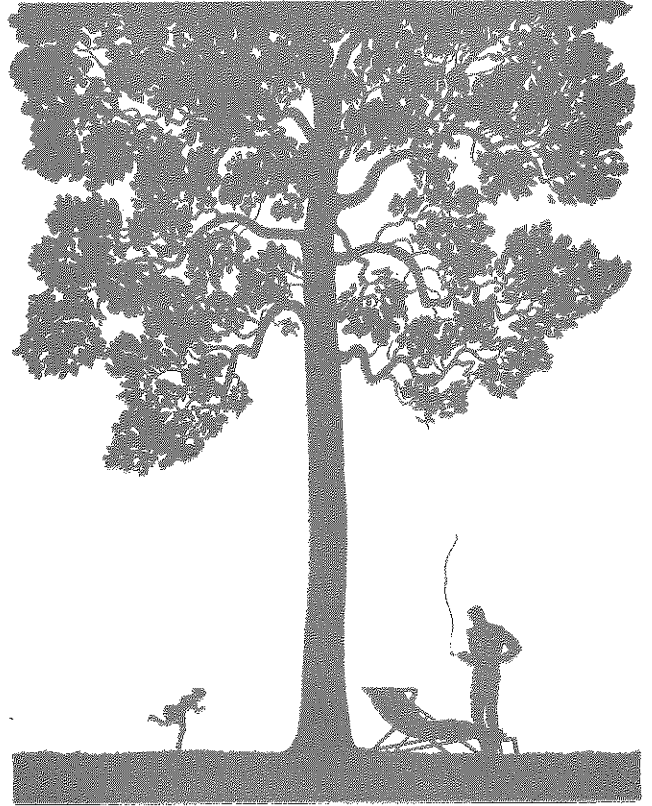

for

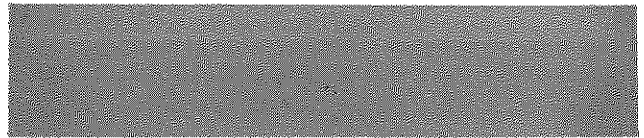

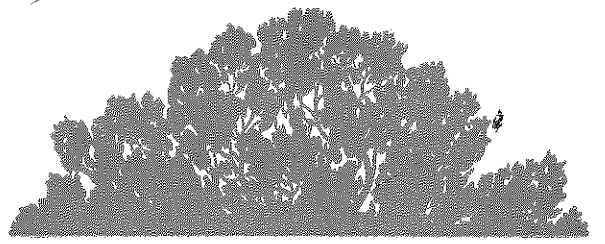

TREE  **TALK**

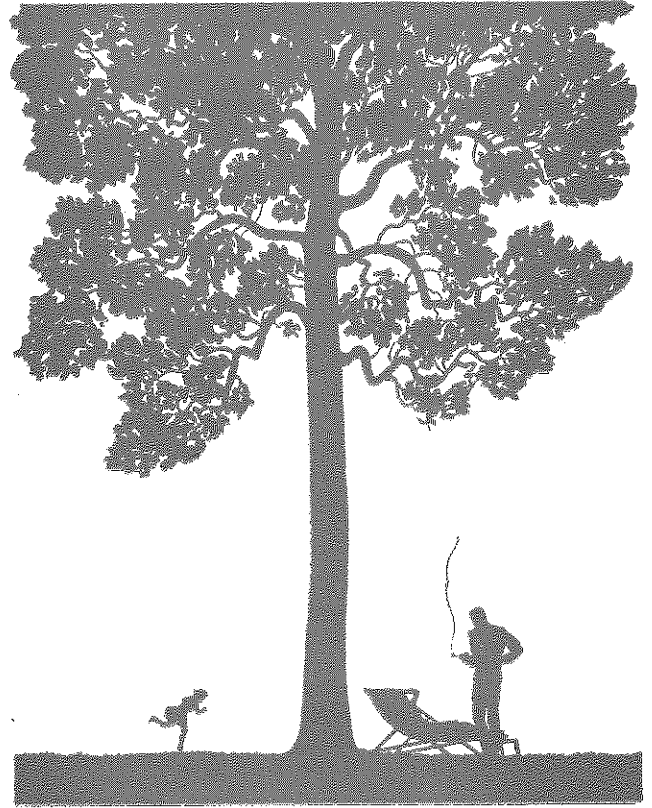

for

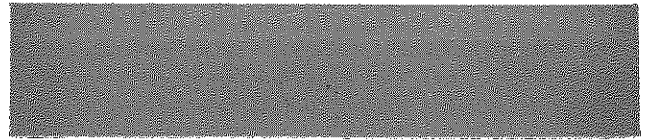

THE ECONOMICAL SERVICE OF A SCIENTIFIC ORGANIZATION

The advice of this organization concerning your trees incurs no obligation. The Bartlett Associate, who presented this memorandum, will gladly confer with you in a neighborly fashion. He is a competent friend of trees, equipped by scientific training to make expert recommendations for their preservation.

Life is not easy for a tree today. It is beset on all sides by insects, disease and thoughtless injuries of man. Deprived by civilization of favorable environment, its natural vigor and resistance lowered, it often fails in its plucky fight to overcome these handicaps. Nature needs the help of man. And that assistance should be preventive rather than corrective—should be given before obvious symptoms show that tree enemies have already made serious inroads.

It is only wise economy to safeguard these valuable possessions, these faithful friends—for they form an important part of the dollar and cents value of your property. And it is only common sense to at least find out their present condition and what may be needed to preserve their natural beauty.

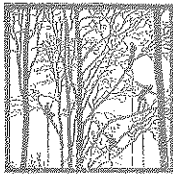

You can trust your priceless trees to Bartlett Dendricians, secure in the knowledge that tree science at its best will be applied to your advantage. They are selected men, trained at The Bartlett School of Tree Surgery, where, under recognized authorities, they receive practical training in actual tree preservation, supplemented

by thorough class room and laboratory instruction.

Bartlett diagnosis and procedure, however, are not matters of individual judgment. All Bartlett practice is based on the accumulated experience and scientific findings of the famous Bartlett Tree Research Laboratories.



Carrying on unceasing research in the various phases of tree care, the leading scientists who conduct the Bartlett Laboratories are developing a technic of practice which is reflected in the enhanced beauty, increased health and longer life of the trees of Bartlett clients.

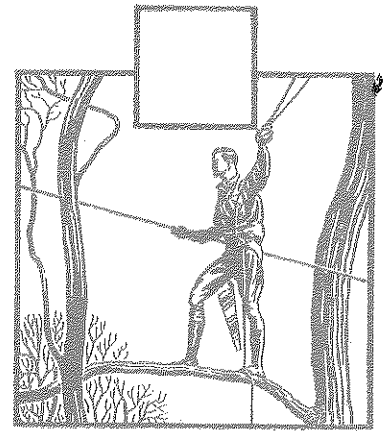

PRUNING

Dead-wood in a tree presents an inviting entrance for certain insects and fungus diseases to invade and ravage the healthy tree parts. The sooner the dead material is pruned away, the quicker protection will be assured.

Excessive dead-wood, however, is generally an outward sign that something is seriously wrong. Pruning alone will not correct the trouble. A thorough inspection is needed to ascertain the cause and the proper scientific steps taken for its removal.

Judicious pruning of trees at the proper time will often avert weak crotches and eliminate the more injurious cutting of larger branches later. Selective Pruning is also used to open up charming vistas of natural beauty, to remove interfering branches and to aid trees suffering from malnutrition. An important measure in tree protection, effective pruning requires a knowledge acquired only by scientific training and practical experience.

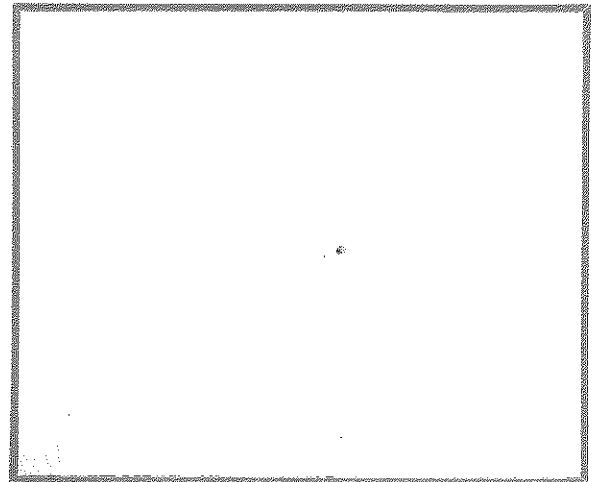

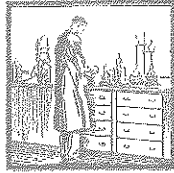

Here was developed the Bartlett Green Tree Food. Made especially for trees after years of experimentation, its nutrients are so balanced and blended that it makes food available as the tree requires it throughout the growing season.

Here was perfected Vick's Nuwud, today's most advanced cavity filling material. Of synthetic wood nature, it closely resembles actual tree-wood. Antiseptic, light and durable, it sways with the tree and practically becomes a part of the tree itself. Nuwud in conjunction with the Bartlett Heal Collar partly explains why Bartlett can guarantee its cavity work free from mechanical defects for the life of the tree.

Bartlett's Heal Collar is an exclusive process of protecting the edges of cavities. The first human surgery to be applied to trees, it aids in sealing the cavity by protecting the newly cut cells. New growth forms rapidly over the cavity edges wherever Bartlett's Heal Collar is used.

To engage Bartlett is to assure yourself of a service based on sound, tried principles of practice, guided and controlled by scientific research. Yet, Bartlett services cost no more. Science, in developing effective procedure, also indicates the most economical methods and recruits the aid of efficient, time-saving equipment of all kinds.

Bartlett Dendricians can give you more actual service per hour than untrained men. There is no loss of time through hesitation or guess work. They proceed directly with the assurance born of seasoned judgment and scientific knowledge.

BARTLETT

EXCLUSIVE BARTLETT FEATURES—VICK'S NUWUD, BARTLETT HEAL COLLAR

THE F. A. BARTLETT TREE EXPERT CO.
Home Office: STAMFORD, CONN.

Branch Offices:

Philadelphia
White Plains
Boston
Westbury, L. I.
Orange, N. J.
Syracuse, N. Y.

Danbury, Conn.
Pittsfield, Mass.
Wilmington, Del.
New Haven, Conn.
Richmond, Va.
Box 8,
West End Station

Bay Shore, L. I.
Box 118
Manchester, Mass.
Washington, D. C.
Box 3103
East Providence,
R. I., Box 144

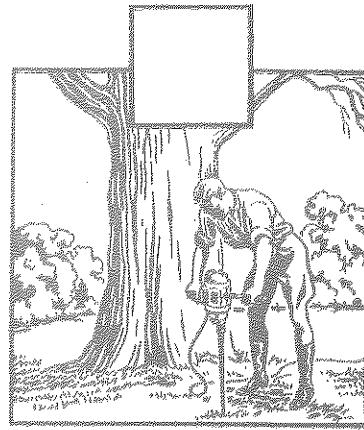

FEEDING

Few owners realize how much their shade trees need feeding. Trees probably suffer more from starvation than from any other cause. Not only does undernourishment bring a loss of health in itself, but it so weakens vitality and resistance that the tree becomes an easy prey of insect and disease attacks.

Trees are living things and proper food is essential. The spread of civilization destroys favorable natural conditions, often changes the drainage, lowers the water table and removes healthful leaf mulch in maintaining well-kept lawns. Repeated droughts, also, as we have experienced in recent seasons, decrease the availability of food.

Scientific tree feeding stimulates healthy growth and materially helps to restore the natural glory of beautiful foliage. For worthwhile results, the food must combine the needed nutrients in a form available when the tree demands nourishment.

3 lbs. of Tree Food
per every inch of
D.B.H.
Holes 18" deep for
large trees, and about
12" for small trees.

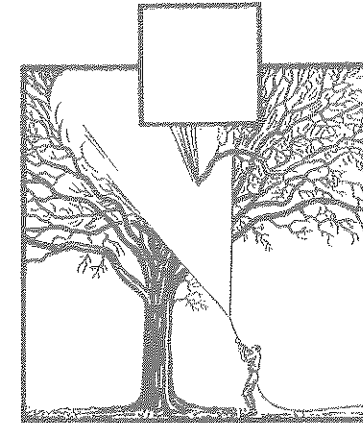

DORMANT SPRAYING

Certain destructive pests, such as scale insects, cause severe injury by inserting their beaks into tender twigs to suck the sap from the inner bark. Twigs and branches are thus killed, the glorious foliage of summer endangered and the general health of the tree seriously menaced.

These tree enemies are best controlled by spraying dormant trees during winter and early spring months. The exact time varies in different localities. When the myriad of baby scale insects emerge to start their destruction, they are most vulnerable and most easily controlled.

The dormant spray is a contact spray which kills the sucking insects. It also assists in controlling some fungus diseases and some leaf-eating insects in the egg stage. Scientifically applied, it is recommended as an effective preventive as well as a controlling measure.

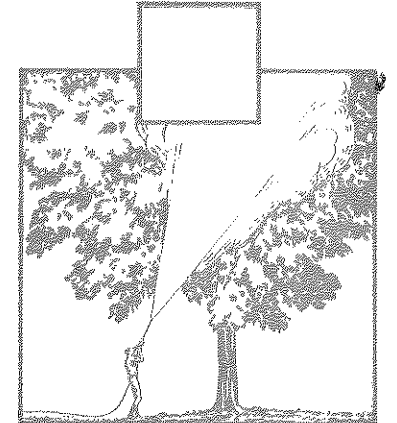
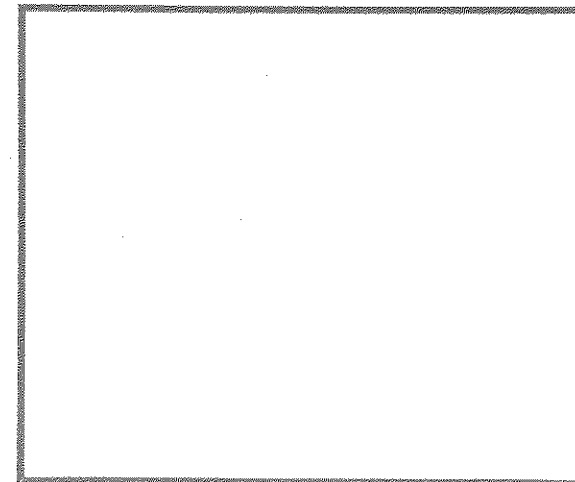

FOLIAGE SPRAYING

A visible and rather common tragedy is the riddled and discolored foliage of trees attacked by pests and disease. No type of tree is free from these menaces, all have their insect and fungus enemies.

Some of these openly and voraciously attack foliage, others strike silently and insidiously. Nearly all have a weakening, destructive effect and if allowed to continue will change a beautiful tree into an unsightly wreck.

Spraying is a scientific method of controlling these inroads of insects and diseases. For leaf-feeders, a stomach poison sprayed on the foliage is generally indicated. The insect is destroyed by consuming this along with its meal of foliage. There are numerous different spray materials and accurate, scientific knowledge is required—not only to prescribe the correct spray for the specific problem, but also to decide when and how to use this material.

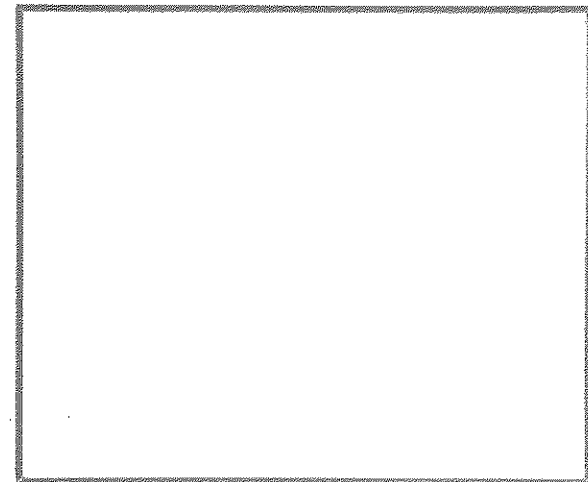

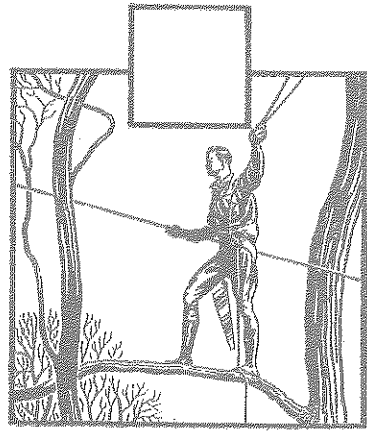

PRUNING

Dead-wood in a tree presents an inviting entrance for certain insects and fungus diseases to invade and ravage the healthy tree parts. The sooner the dead material is pruned away, the quicker protection will be assured.

Excessive dead-wood, however, is generally an outward sign that something is seriously wrong. Pruning alone will not correct the trouble. A thorough inspection is needed to ascertain the cause and the proper scientific steps taken for its removal.

Judicious pruning of trees at the proper time will often avert weak crotches and eliminate the more injurious cutting of larger branches later. Selective Pruning is also used to open up charming vistas of natural beauty, to remove interfering branches and to aid trees suffering from malnutrition. An important measure in tree protection, effective pruning requires a knowledge acquired only by scientific training and practical experience.

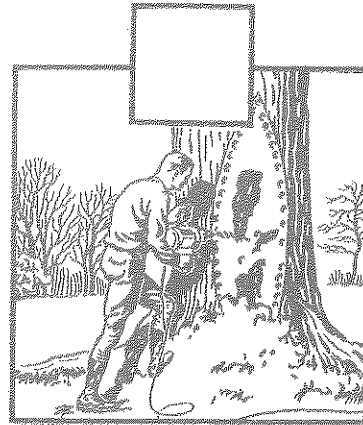
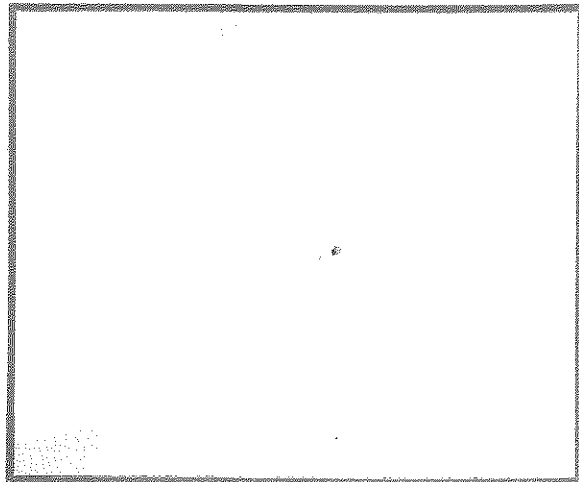

CAVITY WORK

Tree injuries are so common that the average person has become oblivious to the danger of neglected wounds. Any opening permitting the entrance of moisture and fungus diseases promotes rapid tree decay.

Prompt closing of the wound means much to tree health, beauty and future value. But an improperly filled cavity is a greater menace than an unfilled one.

The primary object of wound treatment is to seal the cavity so as to halt further activity of wood-destroying fungi and insects. Healthy, rapid growth over the cavity is assured by Vick's Nuwud and Bartlett's Heal Collar. Vick's Nuwud, unlike concrete, has the desired lightness, flexibility and adhesiveness.

Cavity treatment, because it must help heal natural defects and is so visible, demands the highest technical skill and scientific background.

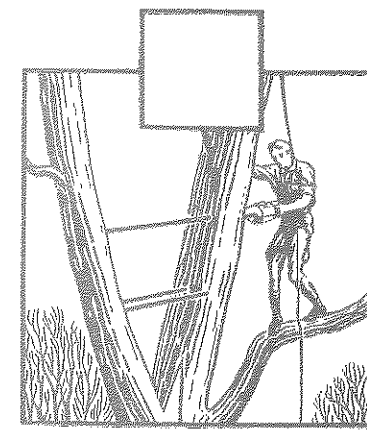
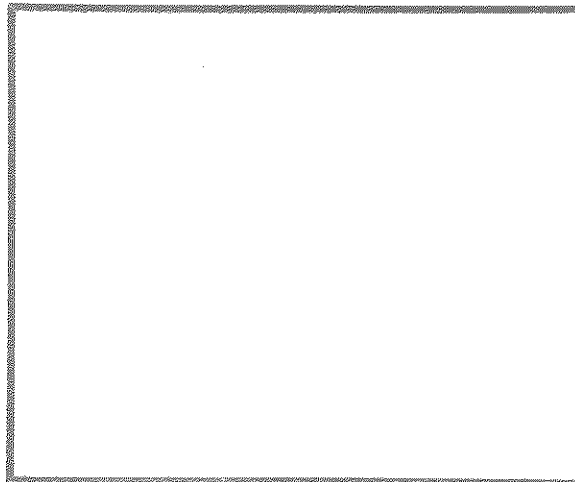

BRACING

Summer winds and winter storms annually injure or destroy thousands of trees, which, if properly braced, could have resisted the pounding of the elements.

Faulty structural growth, such as weak crotches or overly heavy limbs, is almost certain to bring disfiguring damage. Eventually a strong wind will either split the tree or cause the total loss of a valuable limb.

Bracing of such trees averts serious injury, preserves shapely beauty and often prolongs tree life for many years. Improper bracing, however, often does more harm than good. Chains or bands, for instance, wrapped around a tree are almost certain to cause strangulation.

Correct bracing calls for a careful study of each individual case, of the stresses and strains likely to occur. It also calls for scientific equipment—modern tools and expert knowledge.

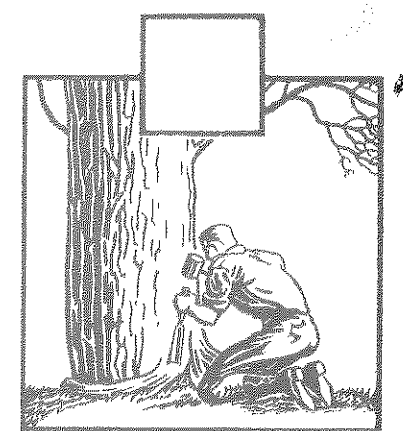
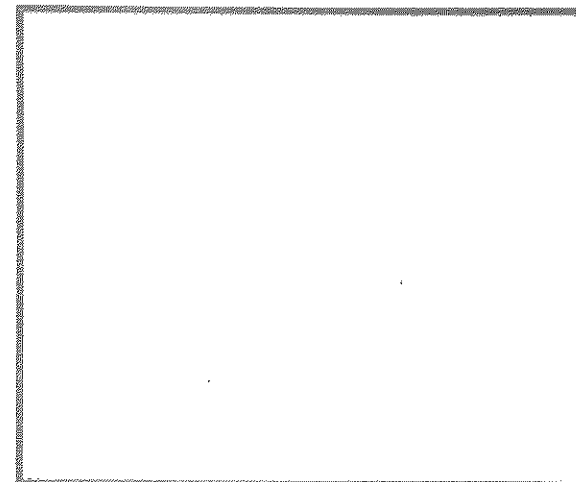

ROOT TREATMENT

Many a fine specimen tree has taken its own life by self-strangulation. A root, deflected from its true course, winds about the stem and gradually but surely cuts off the flow of life-giving sap.

As the growth above and below the girdling root is restricted, this area then becomes inactive. Insects and wood-destroying fungi soon find entrance and the once beautiful tree gradually enters into a period of decay. When the tree owner discovers this condition, the decay, hidden from the casual eye, has usually progressed too far to overcome.

Careful, scientific work will save the tree if started soon enough. Cutting of the root is sometimes a sufficient remedy, but frequently expert, painstaking removal of the root is required.

The roots themselves are readily injured by many things. Scientific practices, such as soil ventilation, root pruning and feeding, remove the cause and overcome the damage.

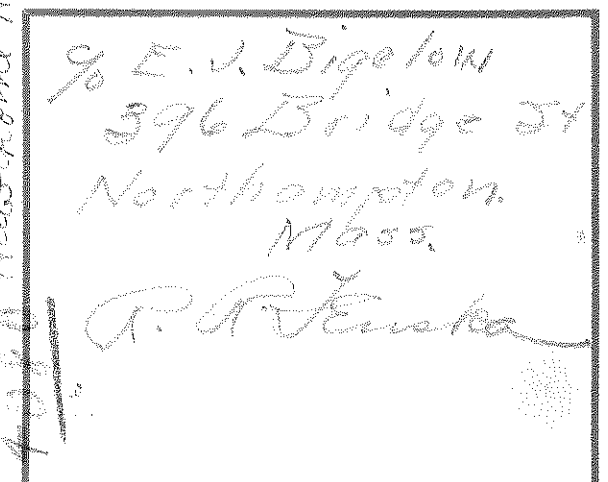

% C. P. Roberts
 North Hampton, Mass.
 % E. J. Bigelow
 396 Bridge St
 Northampton,
 Mass.
 R. R. Kuska

Society of American Foresters

New England Section

Further
from Town 11a.
Office of the Secretary
Further
n. n. of Giddard 17a.
Westerly
n. n. of from Chas. H. Morel,
57a.

Petersham, Massachusetts

Bees Lot 200 a.

Williams (Westerly)
formerly Williams and now a family one Town 107 ads.

Northwesterly
formerly Hubbard Peckham 24 ads

Book 2249
p. 188

Northwesterly
19a.

Northwesterly
76a.

Northwesterly
78a.

"a"

Water Lot 46 a 72 a.

Hubbard Peckham by
Thomas Curtis

Book
2344
p. 119

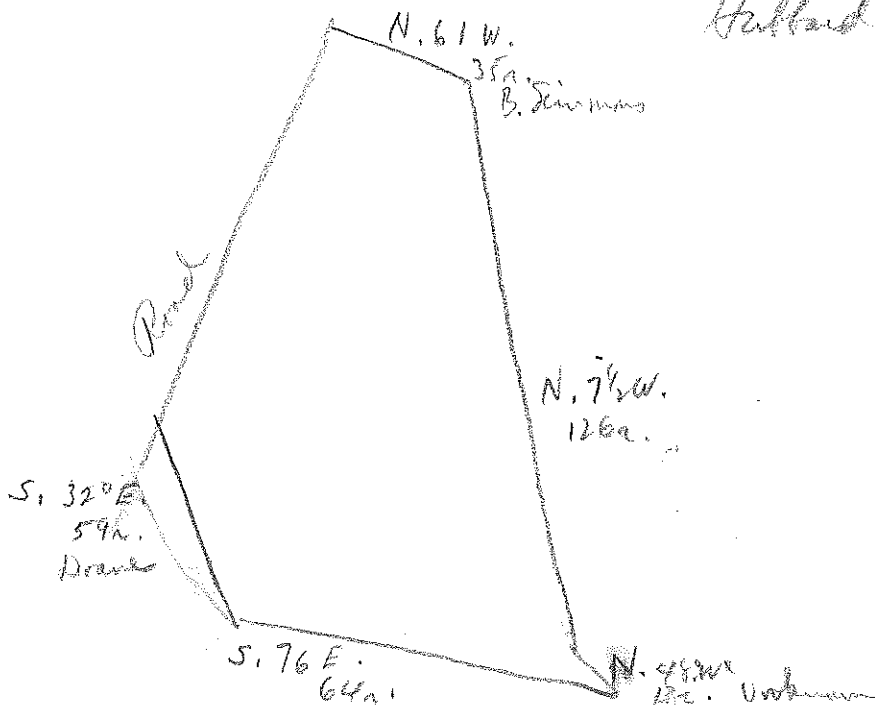

Trunk
Trunk
Trunk

Agave



Trunk

Trunk

Williams
Trunk



Agave

Trunk
Trunk