

UNITED STATES DEPARTMENT OF AGRICULTURE
FOREST SERVICE
NORTHEASTERN FOREST EXPERIMENT STATION
102 MOTORS AVENUE
UPPER DARBY, PENNSYLVANIA 19082

IN REPLY REFER TO:

7140

December 14, 1965

Professor M. Gould,
Forest Economist
Harvard Forest
Petersham, Massachusetts 01366

Dear Ernie:

We have a set of forest-cover type maps for Massachusetts made by our Forest Survey field crews in 1953-1954. These are shown on U.S.G.S. topographic sheets, which I think will be more useful to you than the White Pine Blister-Rust Control maps that you mentioned. In the meantime, we have asked our Region 7 Blister Rust Control people to check for the maps that you have requested.

Enclosed are four quadrangle sheets (1" equals approximately 2,600') that cover the Petersham area: Athol, Barre, Petersham, and Quabbin Reservoir. The forest types were designated as follows:

- 5 Gray birch-pin cherry
- 8 White pine- hardwood
- 9 Oak - white pine
- 10 White pine
- 26 Black ash-elm-red maple
- 51 Oak-hickory

After you have finished using these sheets, I would appreciate your returning them to Carl Mayer, in charge of our Forest Survey.

Sincerely yours,
RALPH W. MARQUIS, Director,

By: 

Encs.



(W.P. BUSTER)
NOTE: THE ORIGINALS OF THIS SURVEY ALONG WITH
SURVEYS OF OTHER TOWNS ARE STORED IN
FILES IN THE MAP ROOM IN THE BASEMENT
G. WHITNEY 7/5/88

UNITED STATES DEPARTMENT OF AGRICULTURE
FOREST SERVICE
EASTERN REGION
FOREST INSECT & DISEASE CONTROL - NORTHERN ZONE
29 COTTAGE STREET
AMHERST, MASS. 01002

IN REPLY REFER TO
5270

January 4, 1966

Dr. Ernest M. Gould, Jr.
Forest Economist
Harvard University
Harvard Forest
Petersham, Massachusetts 01366

Dear Dr. Gould:

Copies of your letter of December 6 to Dr. Marquis and Mr. Allison's reply of December 15 were received here while I was on vacation over the holidays. Please excuse the delay in writing to you.

All of the blister rust control maps in Massachusetts are in the possession of Mr. V. C. Lilley our District Leader, Blister Rust Control, located at 13 Miles Street, Greenfield, Massachusetts.

Through a copy of this letter and copies of your letter and Mr. Allison's reply, I am asking Mr. Lilley to call on you to show you maps he has of Petersham. If he has maps of use to you, he is authorized to provide you with copies and provide any other information he may have.

If we can be of further help, please let us know.

Sincerely yours,

M. R. Mulholland

M. R. MULHOLLAND
Zone Supervisor



January 27, 1966

Mr. V. C. Lilley
U.S.D.A. Forest Service
Blister Rust Control
13 Miles Street
Greenfield, Mass.

Dear Mr. Lilley:

I certainly appreciate your help in locating copies of the blister rust maps of Petersham. It was very kind of you to come to the Harvard Forest and explain about the origin of these maps, their coverage, and the like.

This letter will acknowledge the fact that we have accepted one set of the Petersham maps for storage in our vault. It is understood that we can use these maps for research purposes, but that your office can take the maps back whenever you need them. We would be glad to store the same maps for the other towns in Massachusetts if it should ever appear desirable. It would be a shame to lose these maps, because they have considerable research interest. Because the Harvard Forest lies partly in Phillipston, I wonder if we could also store the maps for that town for you?

Sincerely yours,

Ernest M. Gould, Jr.
Forest Economist

EMG/jws.

PRESERVE

STATES DEPARTMENT OF AGRICULTURE
FOREST SERVICE
U. S. FOREST SERVICE
NORTHERN I&DC ZONE
29 COTTAGE STREET
AMHERST MASS 01002

POSTAGE AND FEES PAID
U. S. DEPARTMENT OF AGRICULTURE

Stored For:

Make copies for
Field Use

old Block Maps

Petersham

MR. V. C. LILLEY
BRC DISTRICT LEADER
13 MILES STREET
GREENFIELD, MASS. 01301

Probably never Made
35,
46-38-39 MISSING

Probably no white lines
in these tracts so no
point in making the maps.

see Key Map of 1920 for Block Nos.

MAPS MADE BY

APR 67

<u>A. O. BICKFORD</u>	BLOCK	3	6	9	14	15	19	21W	22	23	24, 25	26
	YEAR	39	39	38	37	37	37	37	37	38	38	38

<u>A. B. COOK</u>	BLOCK	1	2	30	31	32	33	34	38E	39E	40	41	42	43
	YEAR	37	37	37	37	37	37	37	37	37	38	38	38	38
		44	45N	45S										
		37	37	37										

<u>L. A. CRUMB</u>	BLOCK	38W	39W	Helped Cook with 31, 33, 34	
	YEAR	37	37		

<u>K. C. GREEN</u>	BLOCK	5	10, 11, 12, 13, 16, 21N	21S	23	24	
	YEAR	39	39	39	37	37	37

<u>HUBBARD</u>	BLOCK	4	7
	YEAR	39	39

<u>H. S. LANG</u>	BLOCK	7	17, 18	20	27	28	29
	YEAR	39	38	38	38	38	38

7 Jan. 1966
WHL

In response to inquiry by E M Gould for
Mr V. C. Lilley, BRC District Leader, 13 miles
street, Greenfield Mass brought over the
Blister Rust Maps he had in his office.

He left these here at the Harvard Forest
for storage. These original maps are filed
under General.

All blocks shown on Map of 1920
except those for 35, 36 & 37⁴⁶ are
available in Mr Lilley's folder.

These particular blocks may never have
been mapped.

In addition to the Petersham maps
Mr Lilley has other town maps available.
These are listed on the back of the folder
in the General file.

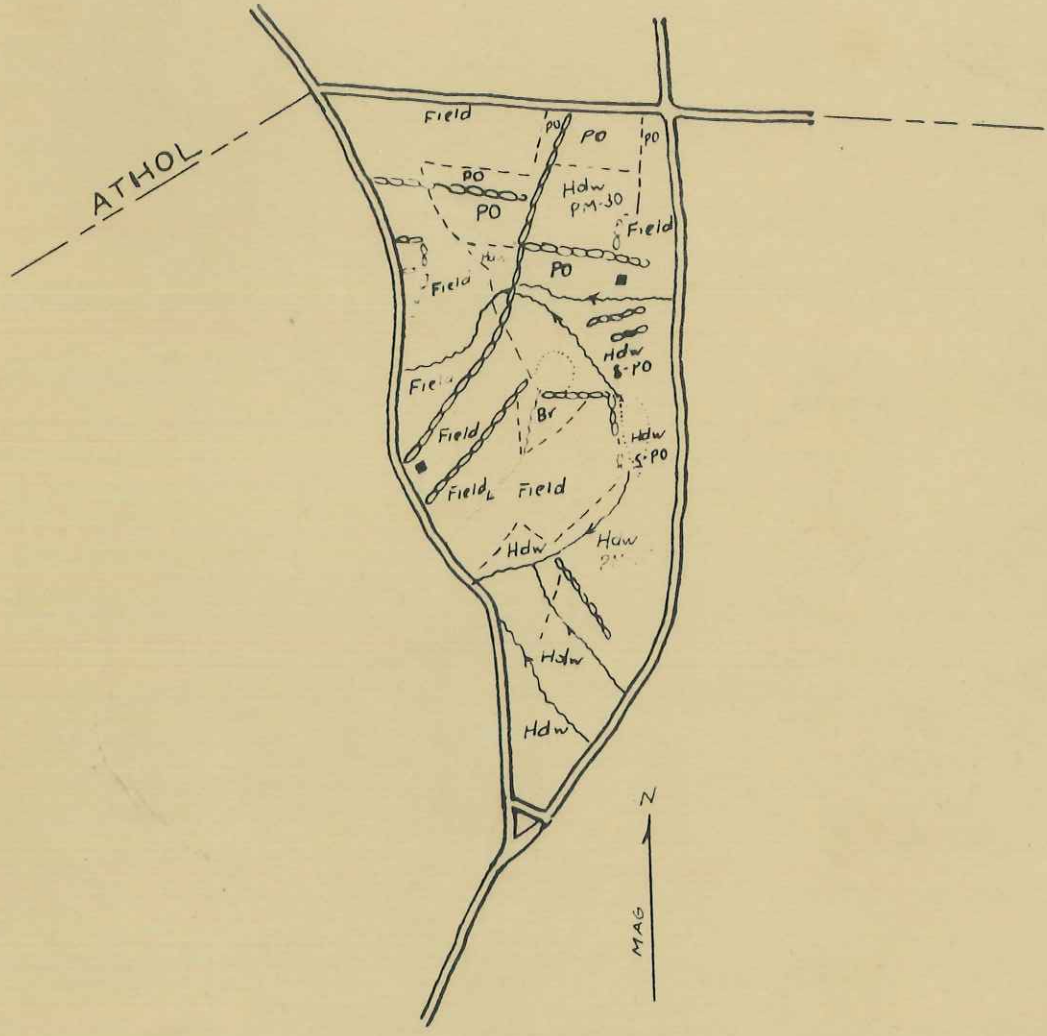

WHITE PINE BLISTER RUST CONTROL
 MAP OF
BLOCK #1

TOWN OF PETERSHAM
 39 ACRES

Scale 1 in. = 650 ft. - AB. Cook, Oct., 1937

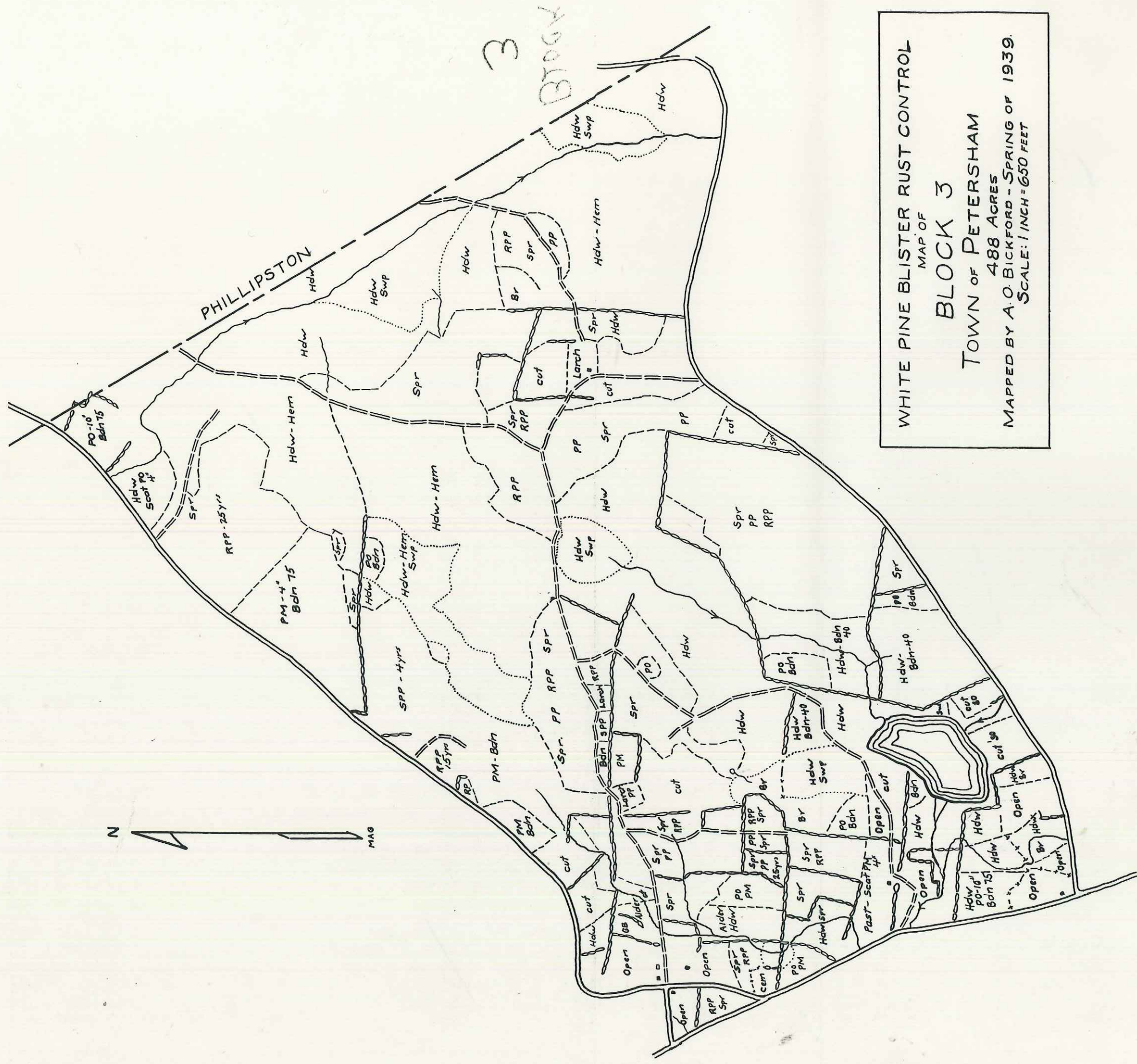

WHITE PINE BLISTER RUST CONTROL
 MAP OF
BLOCK 3
 TOWN OF PETERSHAM
 488 ACRES
 MAPPED BY A. O. BICKFORD - SPRING OF 1939.
 SCALE: 1 INCH = 650 FEET

BLISTER RUST CONTROL
 MAP OF
BLOCK 4
 TOWN OF PETERSHAM
 510 ACRES
 MAPPED BY HUBBARD - MAR. 1939
 SCALE: 1 INCH = 650 FEET

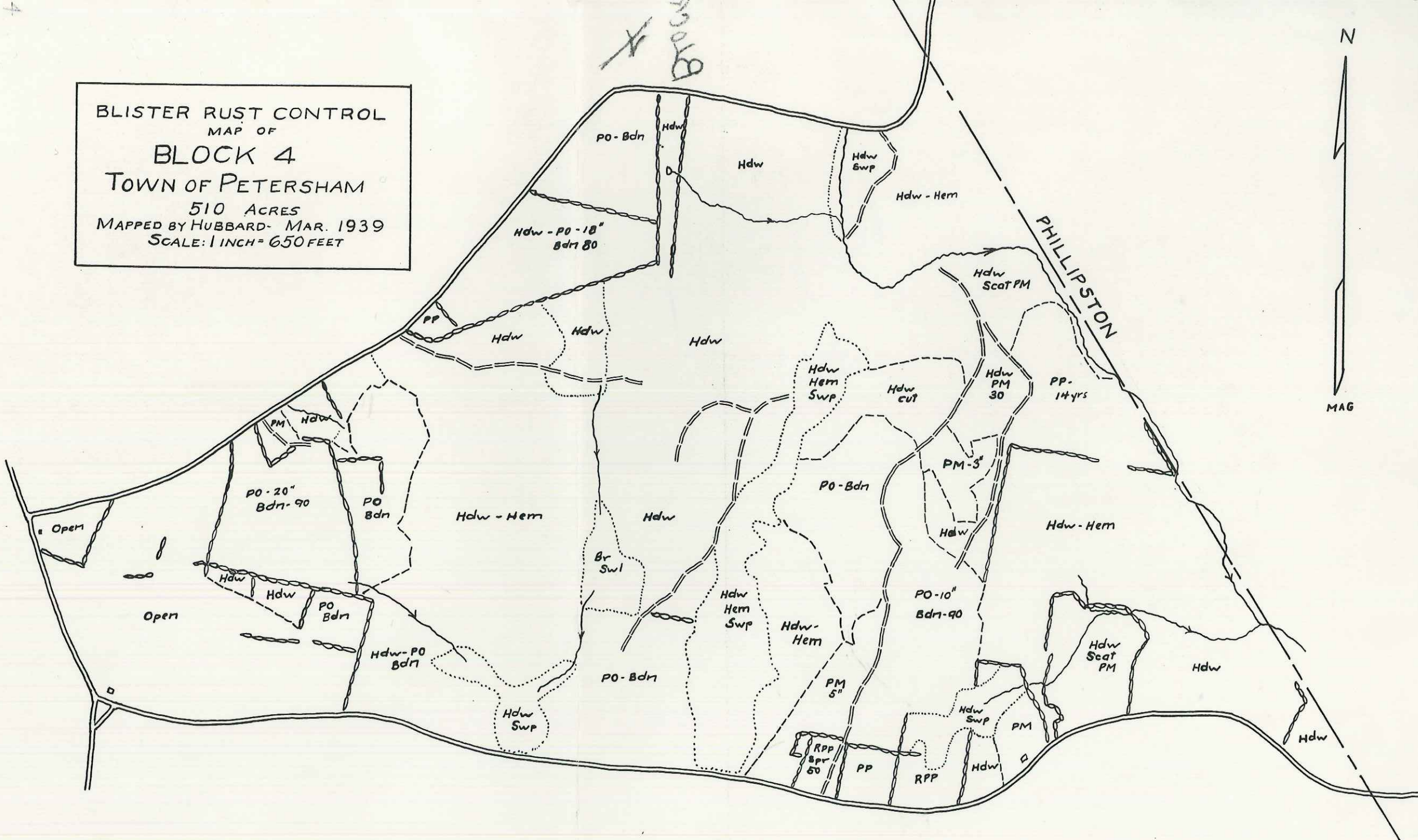

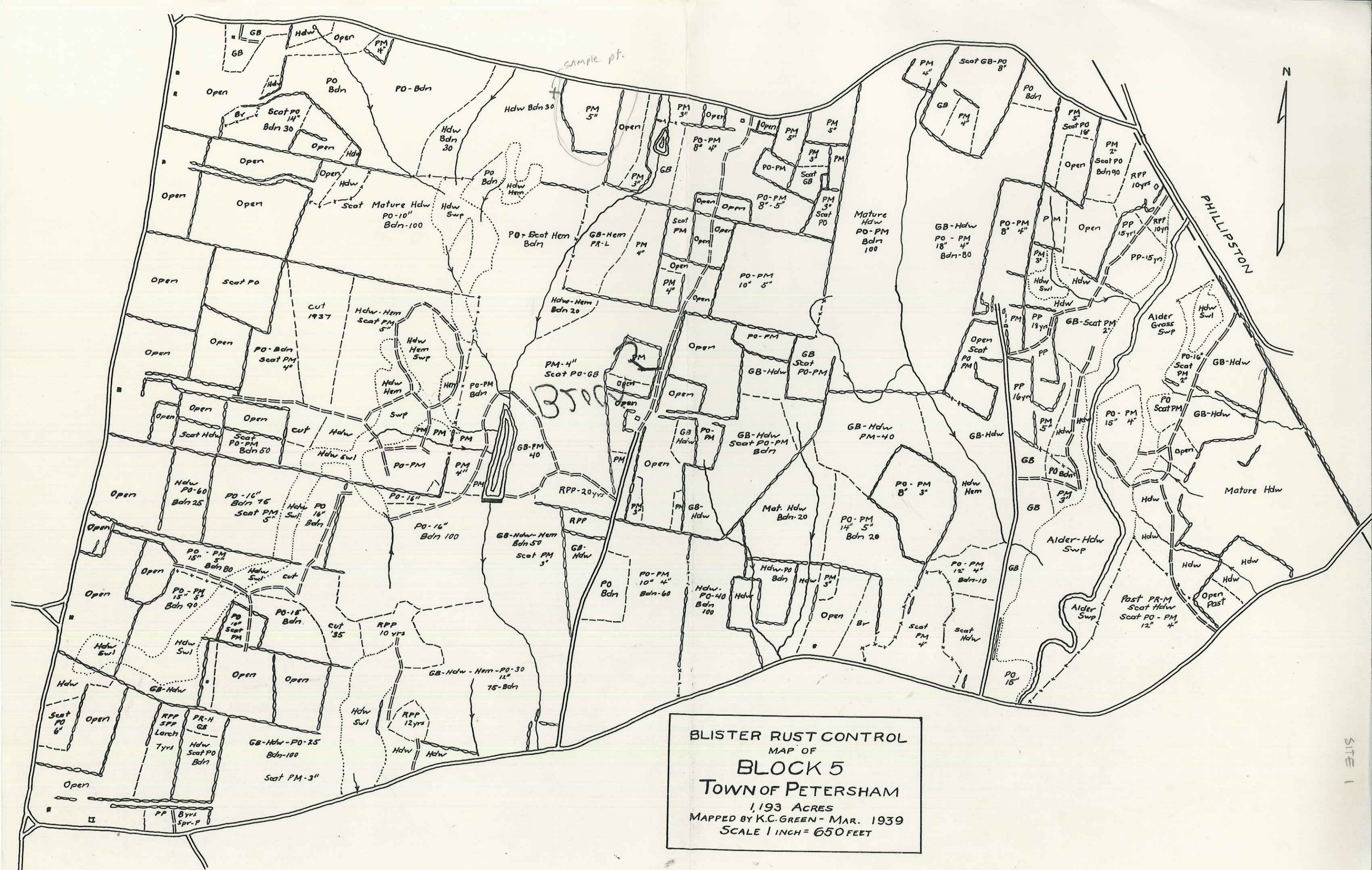

BLISTER RUST CONTROL
 MAP OF
BLOCK 5
 TOWN OF PETERSHAM
 1,193 ACRES
 MAPPED BY K.C. GREEN - MAR. 1939
 SCALE 1 INCH = 650 FEET

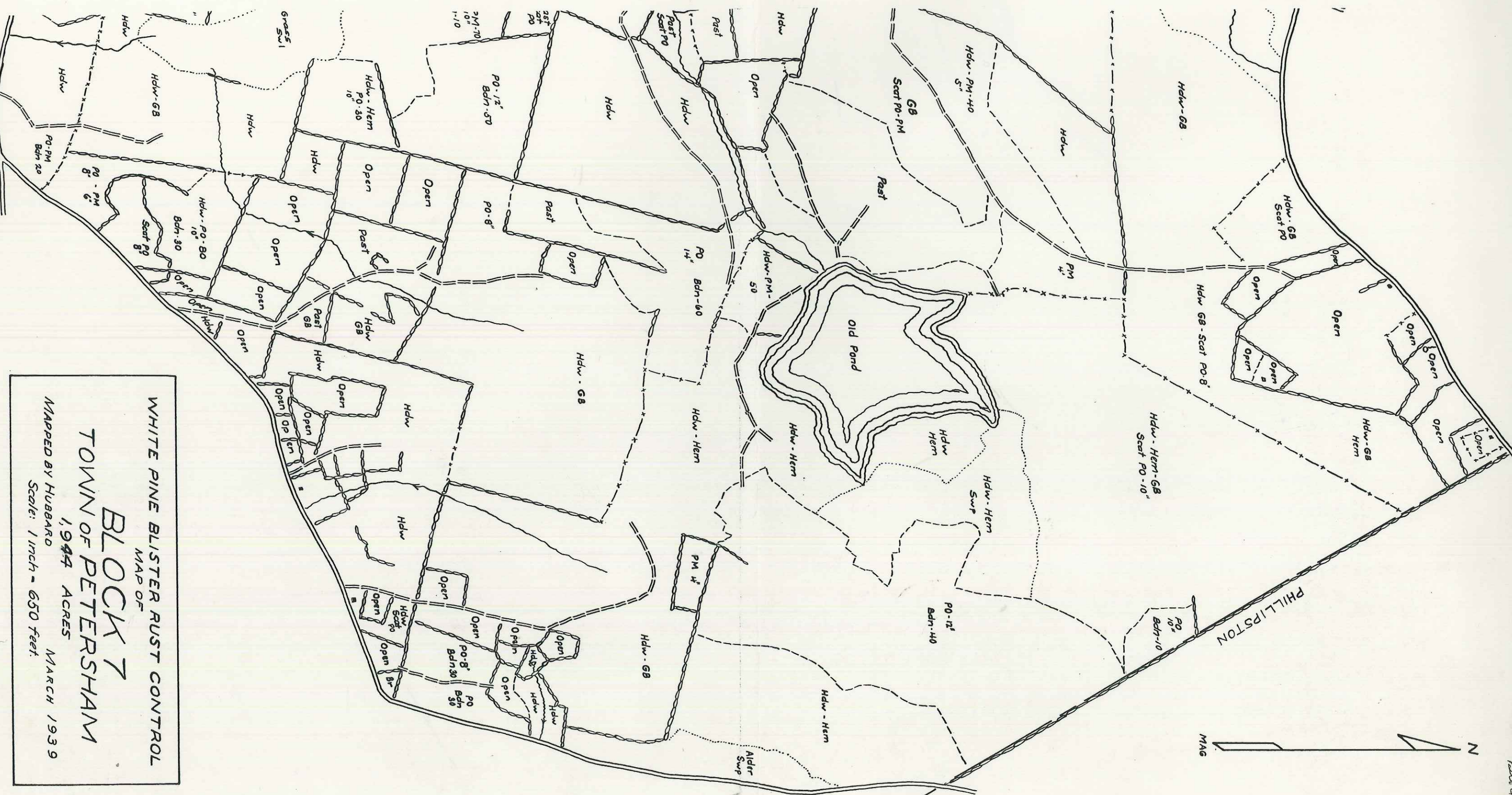

WHITE PINE BLISTER RUST CONTROL
 MAP OF
BLOCK 7
 TOWN OF PETERSHAM
 1,944 ACRES
 MAPPED BY HUBBARD
 Scale: 1 inch = 650 feet
 MARCH 1939

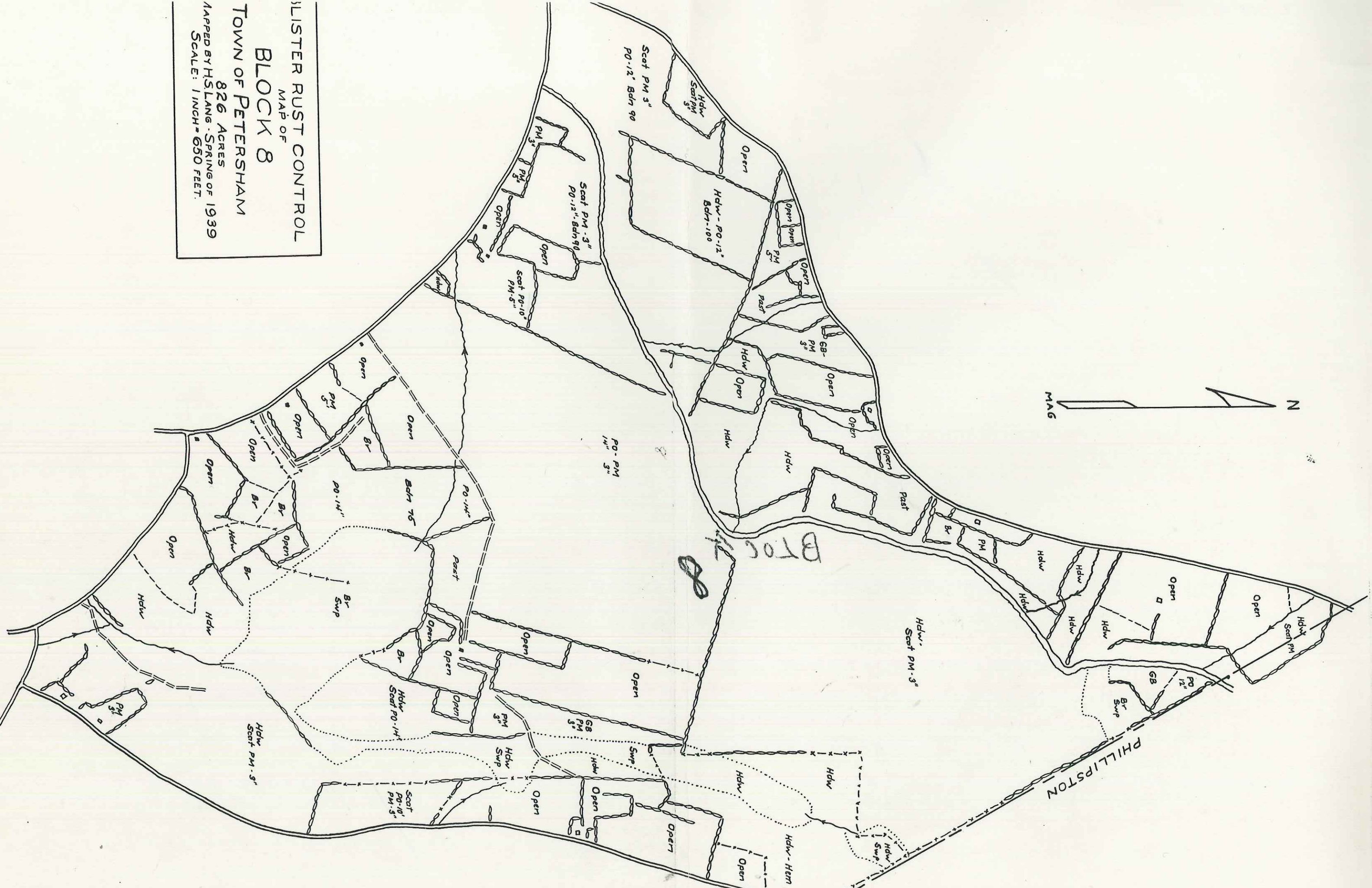

LISTER RUST CONTROL
MAP OF
BLOCK 8
TOWN OF PETERSHAM
826 ACRES
MAPPED BY H. SLANG SPRING OF 1939
SCALE: 1 INCH = 650 FEET.



BLISTER RUST CONTROL
 MAP OF
BLOCKS 10 & 11
 TOWN OF PETERSHAM
 BLOCK 10 - 70A. BLOCK 11 - 210A
 MAPPED BY K.C. GREEN - SPRING 1939
 SCALE: 1 INCH = 650 FEET

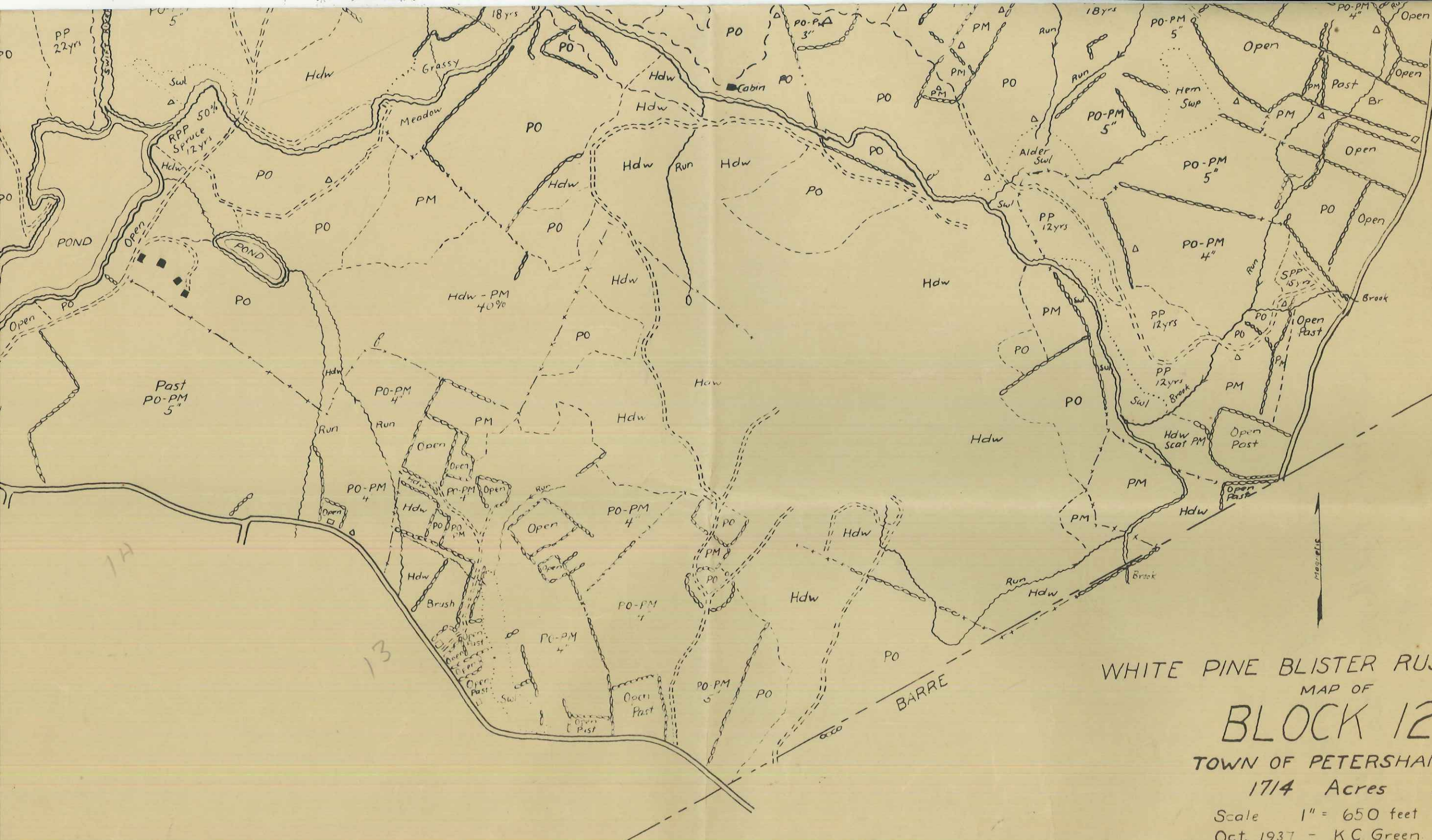

WHITE PINE BLISTER RUST CONTROL
 MAP OF
BLOCK 12
 TOWN OF PETERSHAM
 1714 Acres JDL
 Scale 1" = 650 feet
 Oct. 1937 - KC Green

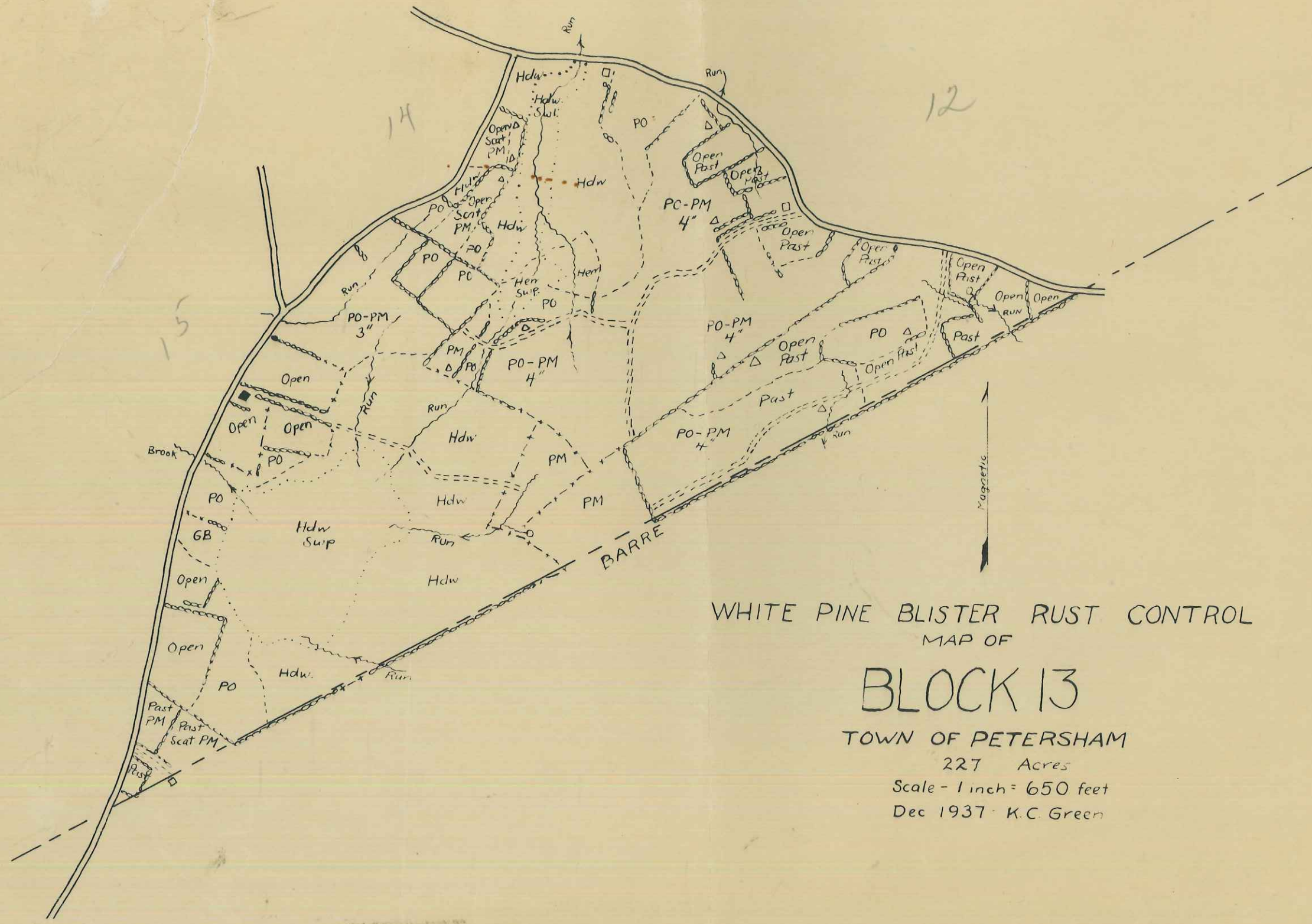

WHITE PINE BLISTER RUST CONTROL
 MAP OF
BLOCK 13
 TOWN OF PETERSHAM
 227 Acres
 Scale - 1 inch = 650 feet
 Dec 1937 - K.C. Green



WHITE PINE BLISTER RUST CONTROL

MAP OF
BLOCK 16

TOWN OF PETERSHAM

485 ACRES

Scale 1 inch = 650 feet

Dec. 1937 - K.C. Green

Block 17

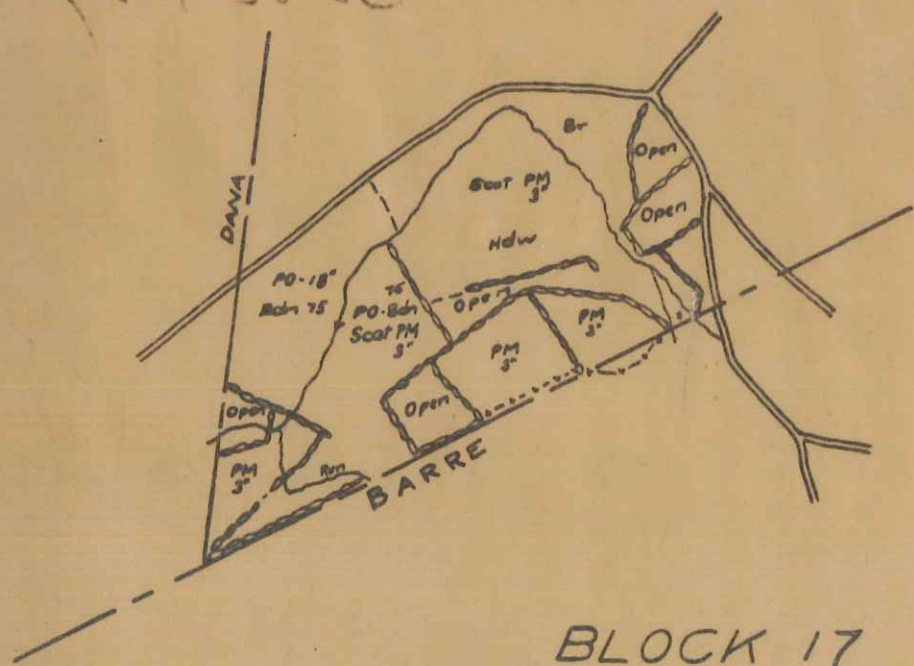

BLOCK 17
TOWN OF PETERSHAM

39 ACRES
Mapped by H.S. Lang - October 1938
Scale: 1 inch = 650 feet.

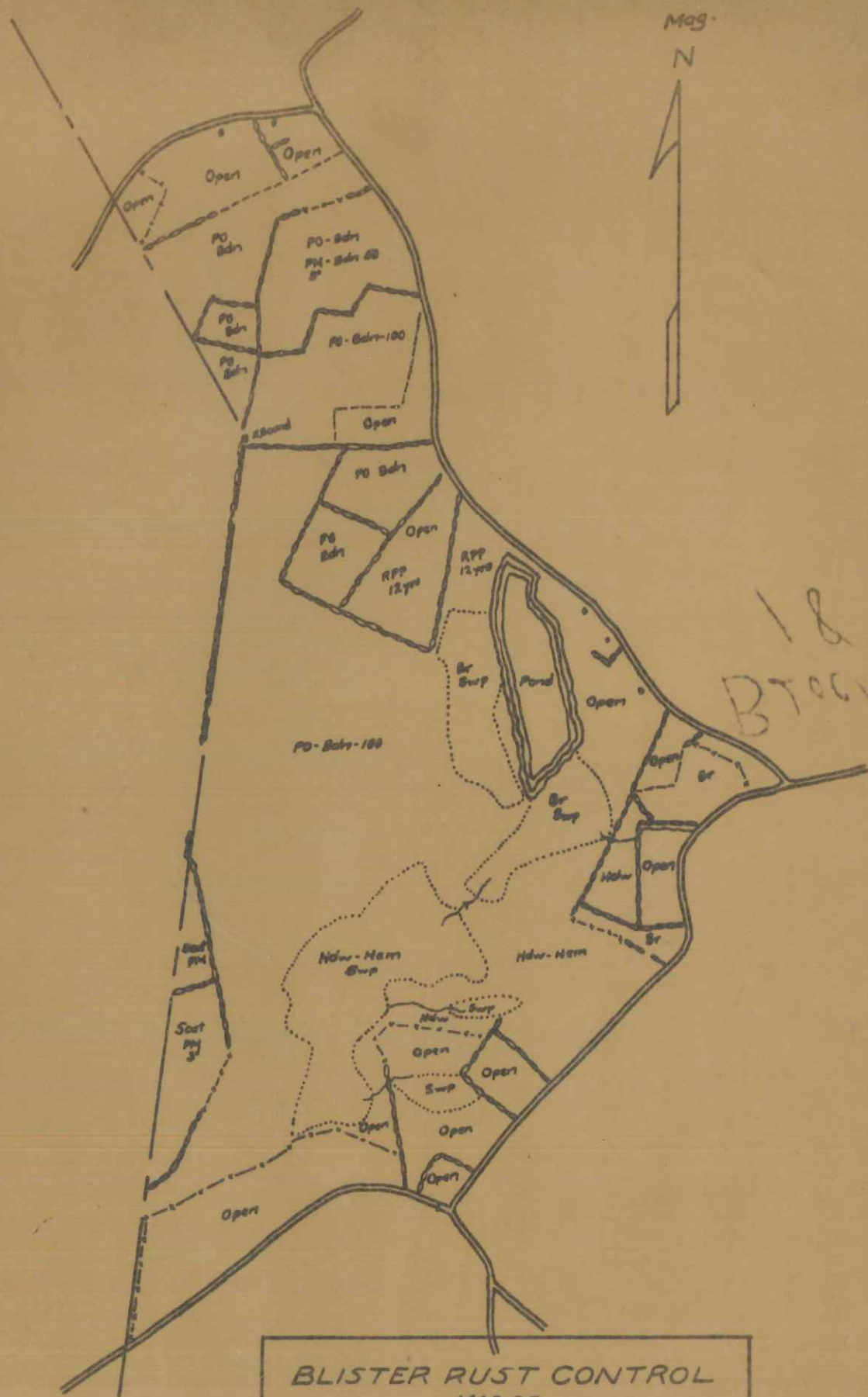

BLISTER RUST CONTROL
 MAP OF
BLOCK 18
 TOWN OF PETERSHAM
 169 ACRES
 MAPPED BY HSLANG - OCTOBER 1938
 SCALE: 1 INCH = 650 FEET.

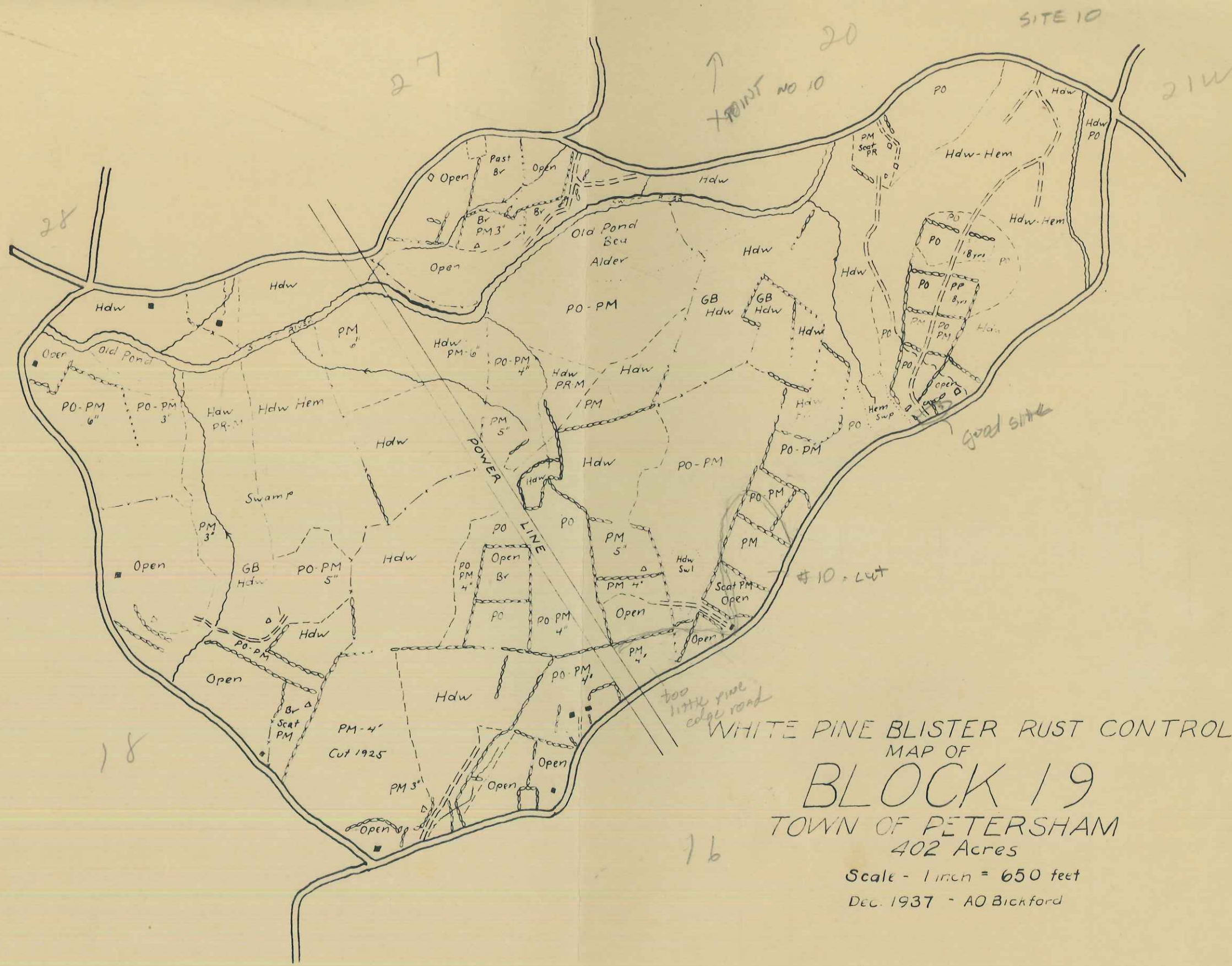

WHITE PINE BLISTER RUST CONTROL
 MAP OF
BLOCK 19
 TOWN OF PETERSHAM
 402 Acres
 Scale - 1 inch = 650 feet
 Dec. 1937 - AO Bickford



WHITE PINE BLISTER RUST CONTROL
MAP OF

BLOCK-21N

TOWN OF PETERSHAM
414 ACRES

Scale 1 inch = 650 feet
Nov. 1937 - K.C. Green

21-N

215

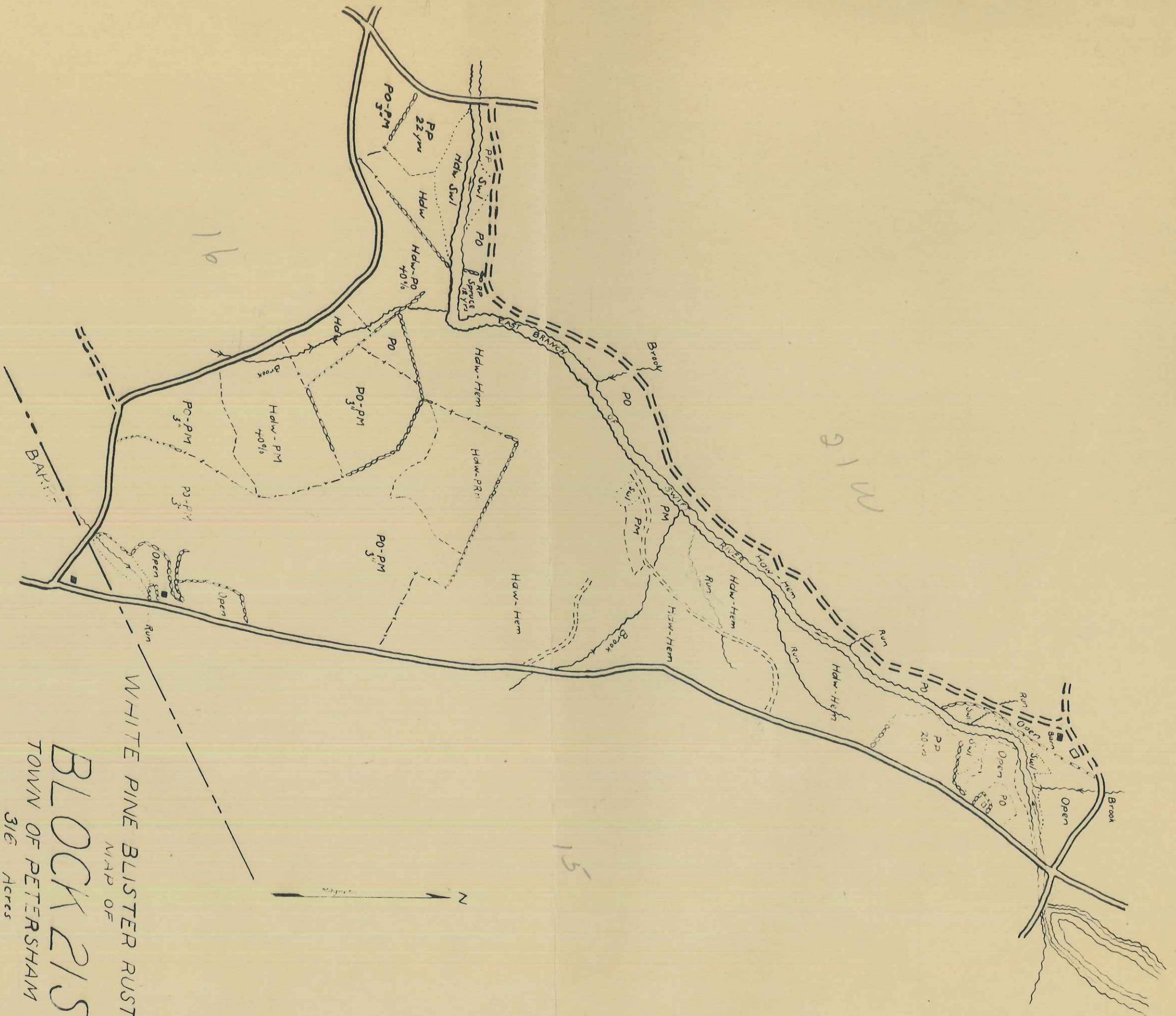

WHITE PINE BLISTER RUST CON
 MAP OF
BLOCK 215
 TOWN OF PETERSHAM
 316 Acres
 Scale 1 inch = 0.50 mile
 Nov 1937 - A.C. Green

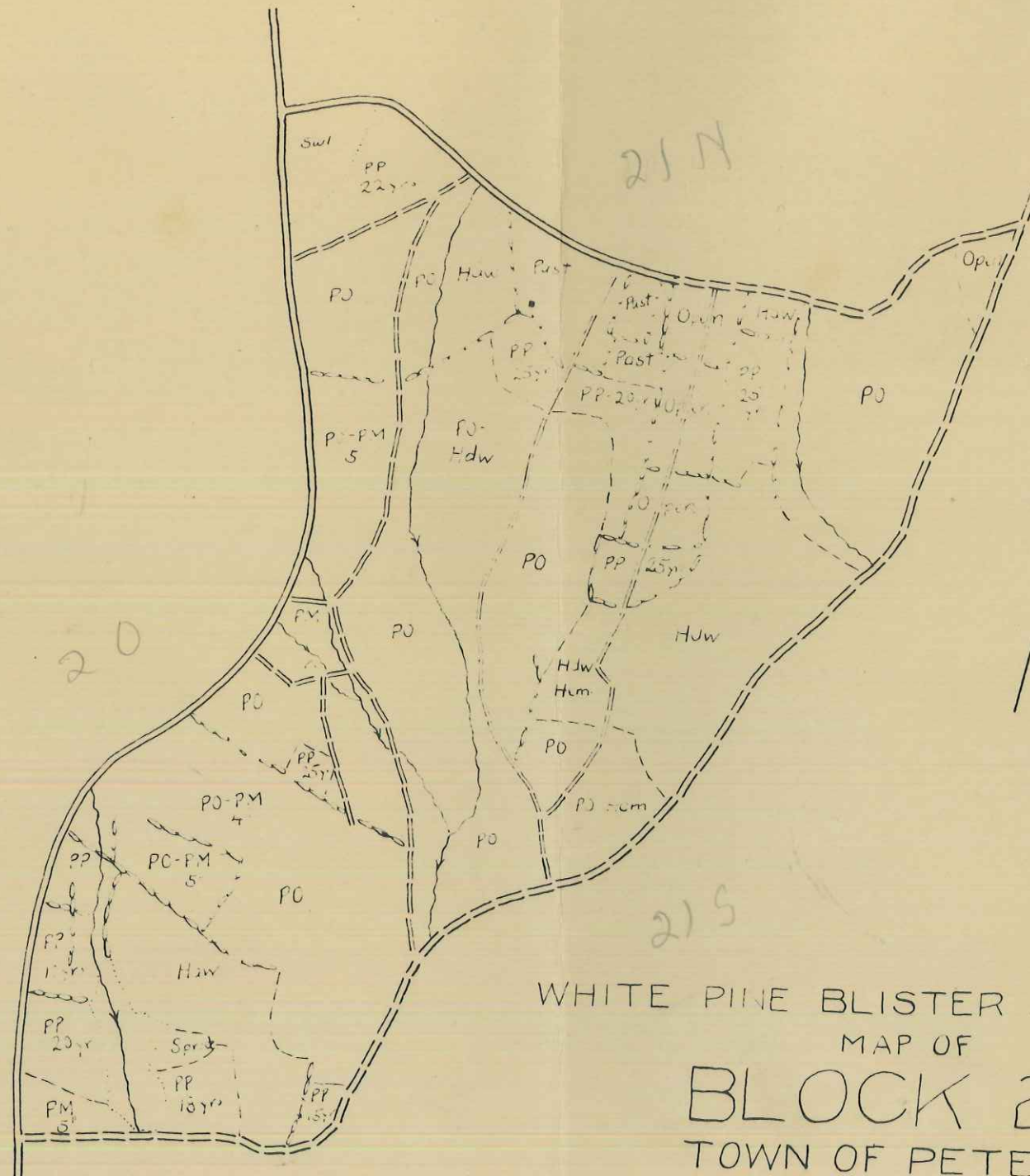

WHITE PINE BLISTER RUST CONTROL
MAP OF

BLOCK 21W

TOWN OF PETERSHAM

236 ACRES

Scale 1 inch = 650 feet

Nov 1937 AOBickford

21W

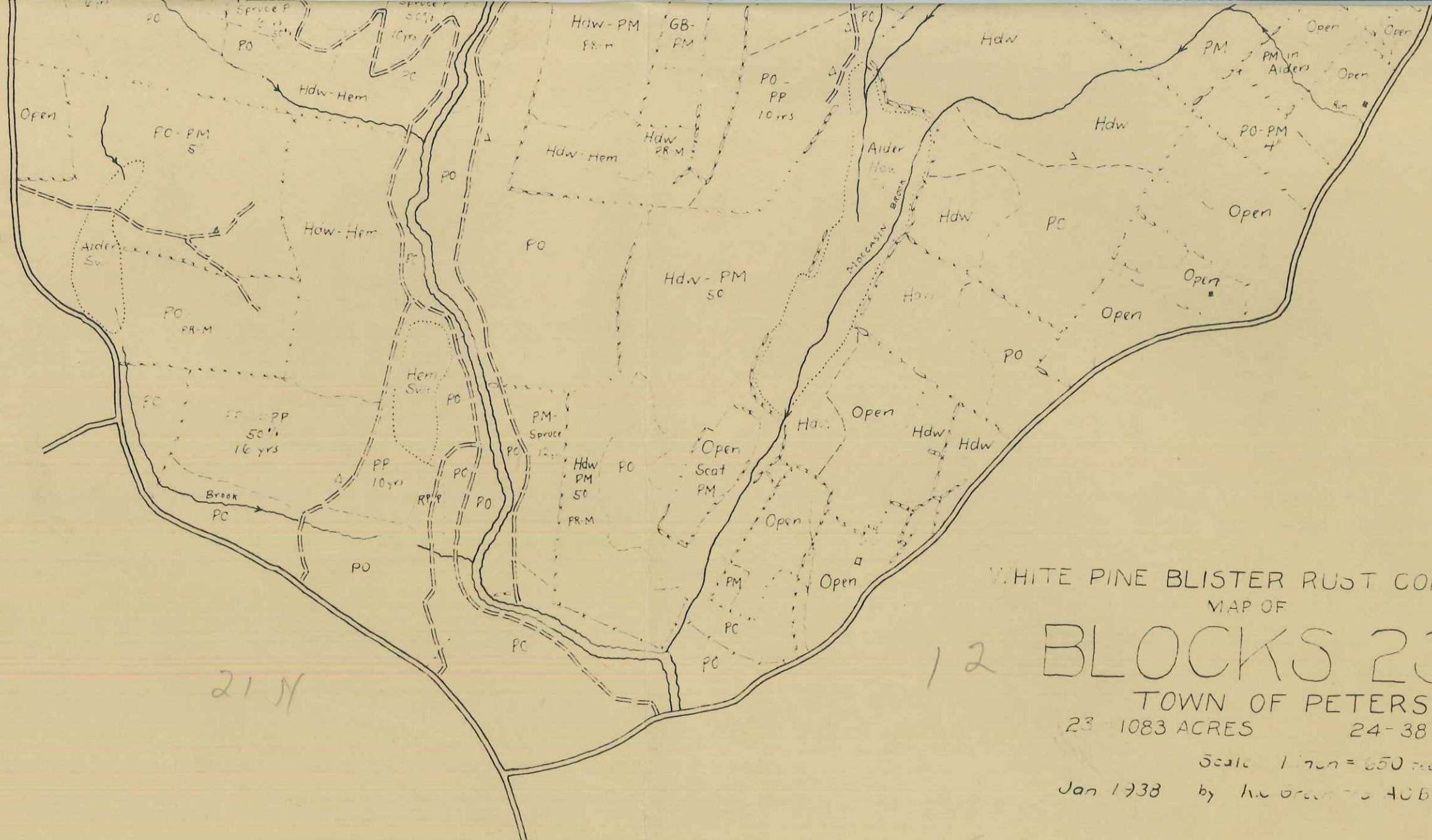

21 N

12

WHITE PINE BLISTER RUST CONTROL
 MAP OF
BLOCKS 23 & 24
 TOWN OF PETERSHAM
 23 - 1083 ACRES 24 - 38 ACRES
 Scale 1 inch = 650 feet
 Jan 1938 by the Greenough-Adams-son